



Mono-crystalline MS(125) Solar Module

RD200MS

200Wp Output Power

Max system voltage 1500V standard

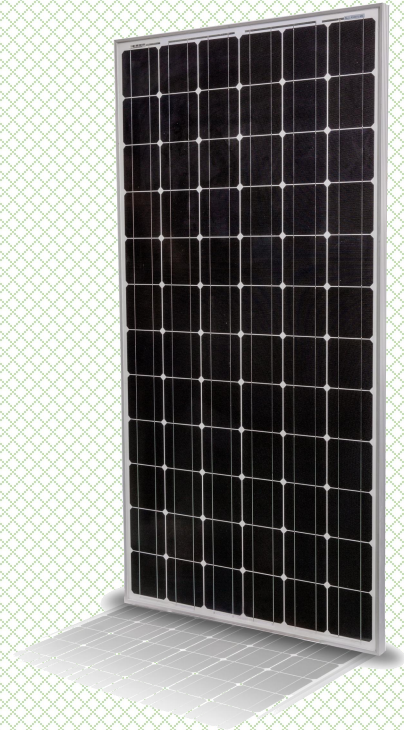

Key Features

- Outstanding Performance in weak-light conditions
- Excellent temperature coefficient
- 0~+5W positive tolerance guarantee reliable power output
- Shortened current collection, path, low series resistance
- More uniform stress distribution, higher anti-crack ability
- Excellent anti-PID module design
- Certified to withstand high wind loads(1600pa) and snow loads(3600pa) of the latest standard test of module mechanical load
- Salt mist and ammonia corrosion resistant

Quality & Environment Certification System

ISO 9001:2015 Quality management systems



ISO 14001:2015 Environment management systems



OHSAS 18001:2007 Occupational health and safety management systems



IEC61215

IEC61730

UL1703

IEC61701

IEC62716

Linear Warranty For Module

10

10-year materials and workmanship Warranty

25

25-year linear performance Warranty

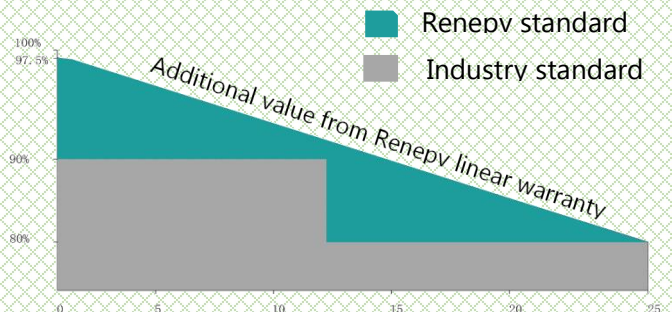

NINGBO RENELED NEW ENERGY CO.,LTD

Add:NO.35 jintong road,binhai industrial park,xiangshan,ningbo city,china

Tell: +86-574-65786319

Fax: +86-574-65786317

Email: info@renewpv.com

Website: www.renewpv.com



Mono-crystalline MS(125) Solar Module

Electrical Data (STC)

Module Type	RD200MS	
Power output	Wp	200
Module efficiency	%	15.6
Voltage at Pmax	V	19.49
Current at Pmax	A	10.26
Open circuit voltage	V	23.24
Short circuit current	A	10.75

STC: 1000W/m² irradiance, 25°C cell temperature, AM1.5g spectrum according to EN 60904-3. Average relative efficiency reduction of 5% at 200W/m² according to EN 60904-1.

Mechanical Data

Cell (quantity)	Mono125x125 72pcs
Sealing material	EVA
Back sheet	White sheet
Front Cover (material / thickness)	low-iron tempered glass(3.2)
Frame(Material Corners,etc.)	35x35#
Junction box (protection degree)	≥ IP67 with bypass-diode
Cable (length / cross sectional area)	Section4.0mm ² /TUV
Plug connector(type/protection degree)	MC4 / IP68 1500VDC
Bypass Diode Rating(A)	20
Standard Test Conditions	AM1.5 1000W/m ² 25°C
Application class	Class A
Fire performance	Class C
Certifications	IEC 61215, IEC 61730

Working Conditions & Temperature

Nominal operating cell temperature	NOCT	44°C±2°C
Temperature coefficient of P _{max}	δ[%/°C]	-0.37
Temperature coefficient of V _{OC}	β[%/°C]	-0.30
Temperature coefficient of I _{SC}	α[%/°C]	0.045
Maximum system voltage (IEC)	VDC	1500
Maximum series fuse rating	A	20
Operating &Storage temperature	°C	-40~+85

Dimensions of PV Module(mm)

Module Dimension	1580×808×35 mm
Weight	15.0kg

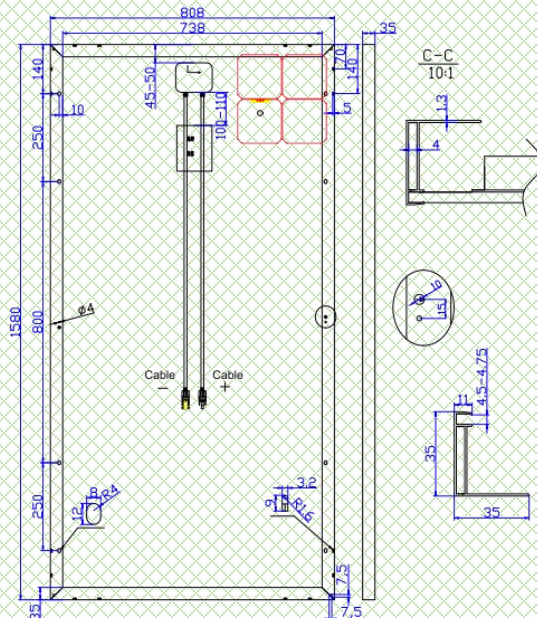

I-V Curves

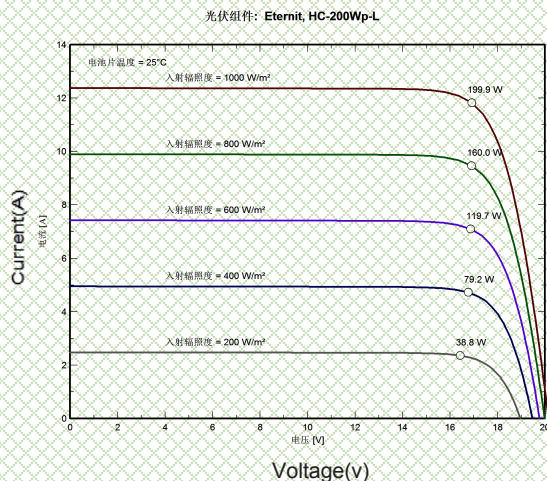

Packing

Packing Pieces per container (bulk shipment)

packing unit	20'GP	40'GP
Pieces per box	1	1
Box per container	498	1240
Pieces per container	498	1240